

NOTES
 316 STAINLESS STEEL
 MIRROR POLISH

FOR REFERENCE ONLY

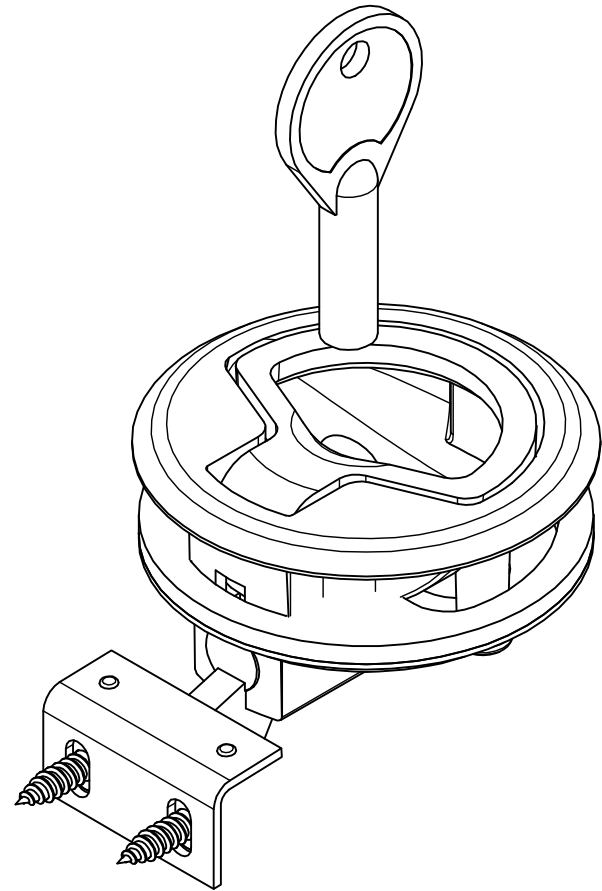

UNLESS OTHERWISE SPECIFIED:
 BREAK ALL SHARP EDGES
 DIMENSIONS ARE IN INCHES
 TOLERANCES:
 FRACTIONAL: $\pm 1/16$
 DECIMAL: $X.X \pm .05$
 $X.XX \pm .03$
 $X.XXX \pm .010$
 ANGULAR: $\pm 3^\circ$
 FINISH: 120Ra

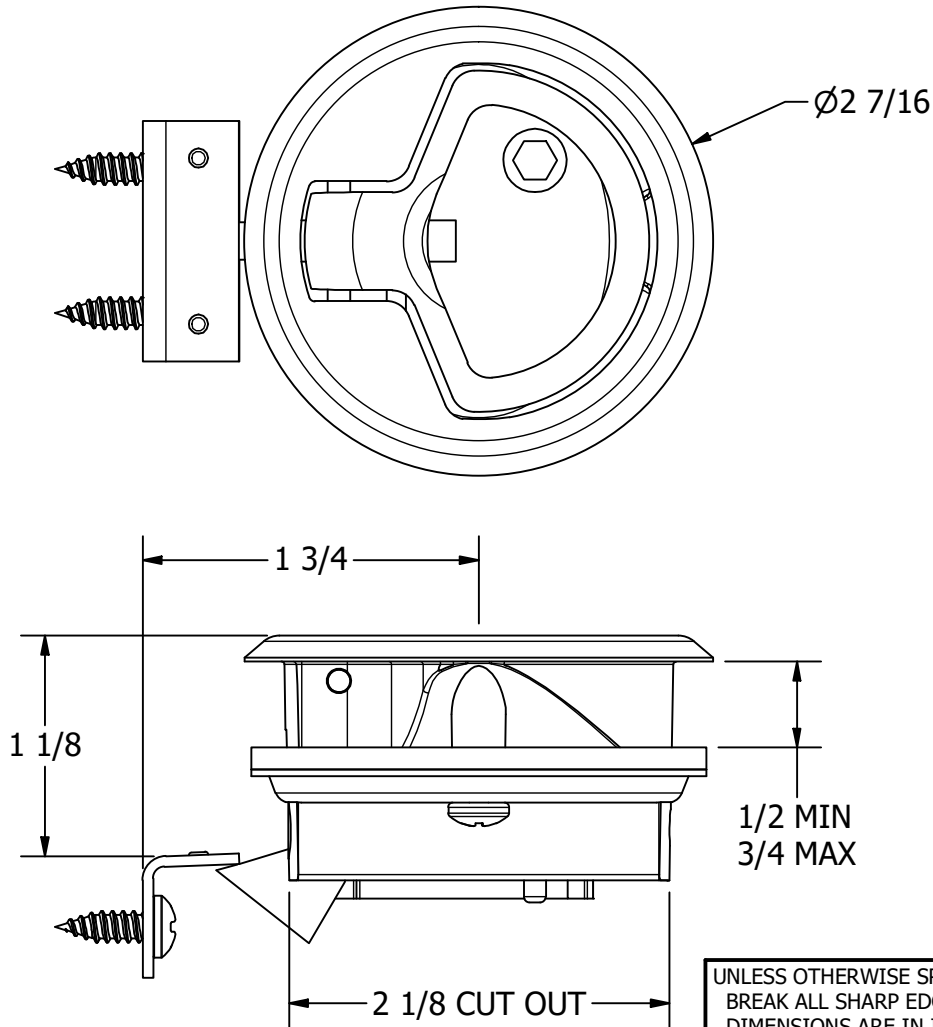

TITLE
 ROUND SLAM LATCH, LOCKING
 PART NUMBER: 7112SLK

PROPRIETARY AND CONFIDENTIAL
 THE INFORMATION CONTAINED IN THIS
 DRAWING IS THE SOLE PROPERTY OF WHITE
 WATER MARINE HARDWARE. ANY REPRODUCTION
 IN PART OR AS A WHOLE WITHOUT WRITTEN
 PERMISSION IS PROHIBITED.

SIZE A	DRAWING NO. WWMH-7112SLK	REV 0
SCALE 1	DRAWN RC	DATE 10/22/2025
		SHEET 1 OF 1